



Open Robotics

Who we are



We create open software and hardware platforms for robotics. We use those platforms to solve important problems and we help others to do the same.

Where we are

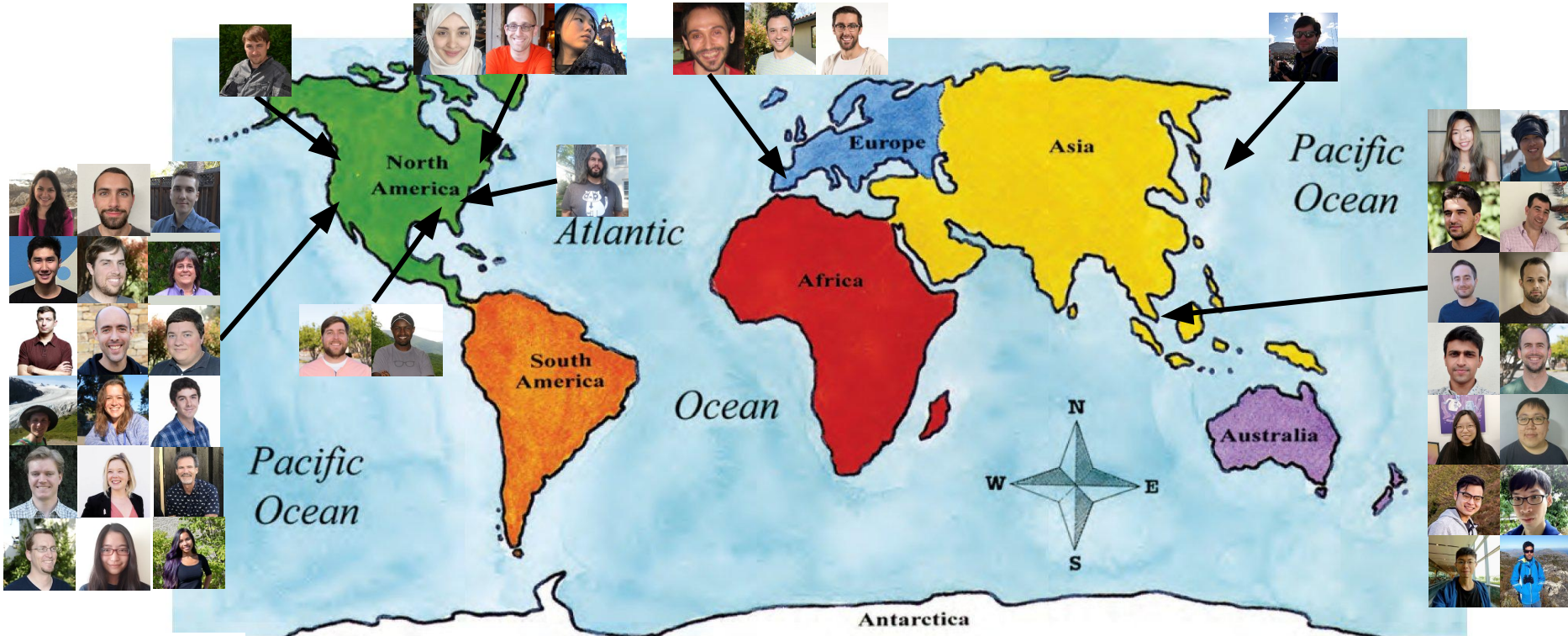

Stewards of robotics FOSS projects:

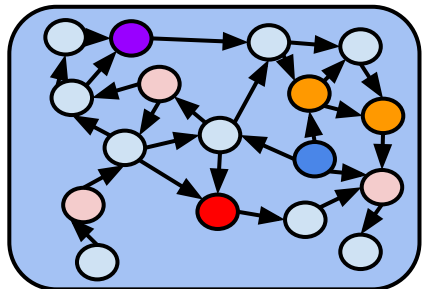

ROS
2

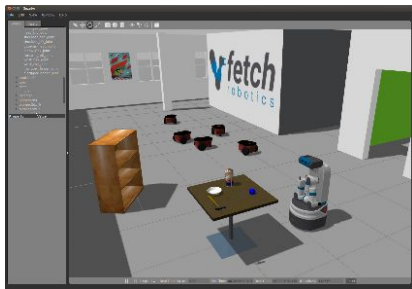

GAZEBO

IGNITION



RMF



Robotics Framework and Tools

ROS 2:

Libraries and tools for programming robots

Used in labs, classrooms and companies around the world



Where is ROS used?

- NASA: Robonaut (ISS), VIPER
- MATLAB: Robotics Toolbox
- Rethink Robotics: Baxter
- ROS-Industrial: (de)palletizing
- RightHand Robotics: ReFlex Hand
- Boston Dynamics: ATLAS
- PAL Robotics: REEM-C
- HERE: 3D mapping cars
- Avidbots: Sweeper and Scrubber
- Blue River Technology: Precision Farming
- ...

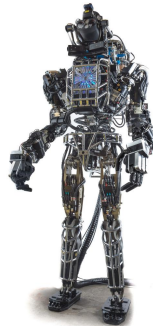
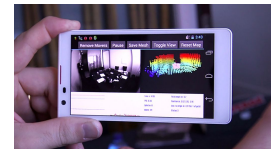
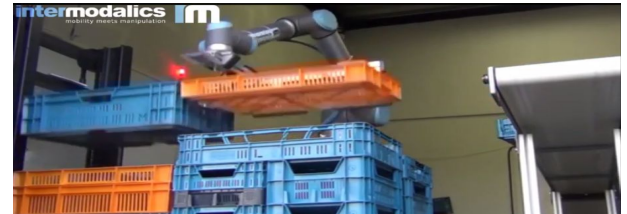

At least \$143.5M in investment (September 2019)



Embark: \$70M Series B



Farmwise: \$14.5M Series A



**Simbe
Robotics**

Simbe: \$26M Series A



Built: \$33M Series B

metrics.ros.org

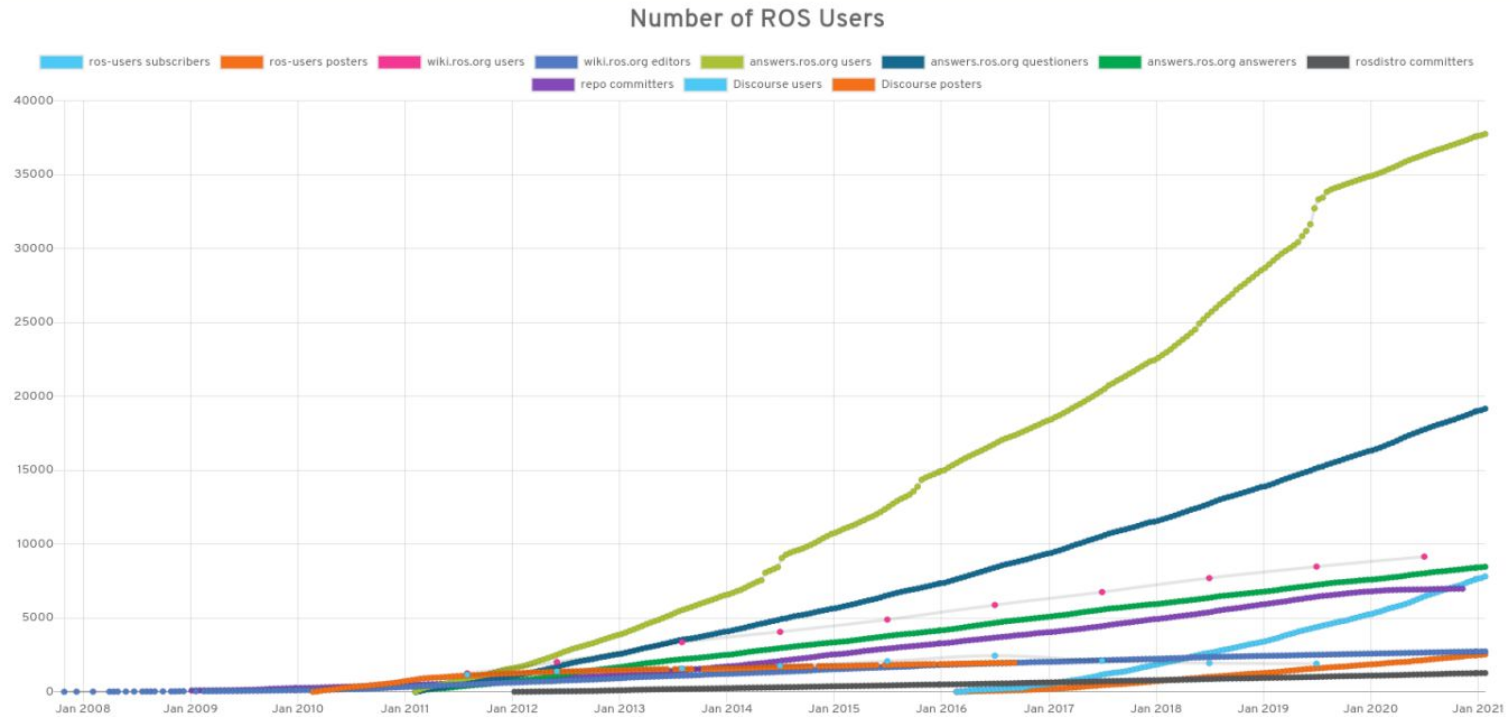



Gazebo



Ignition

Robotics Simulation

ROS
internal robot software

GAZEBO
simulated world

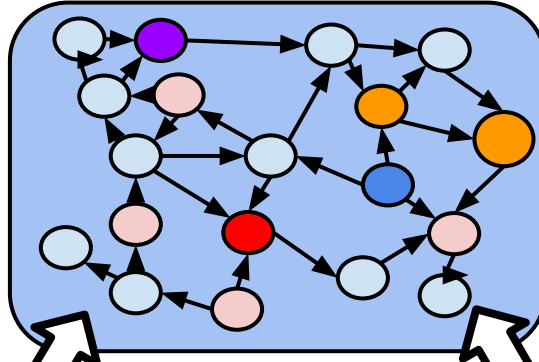

real world

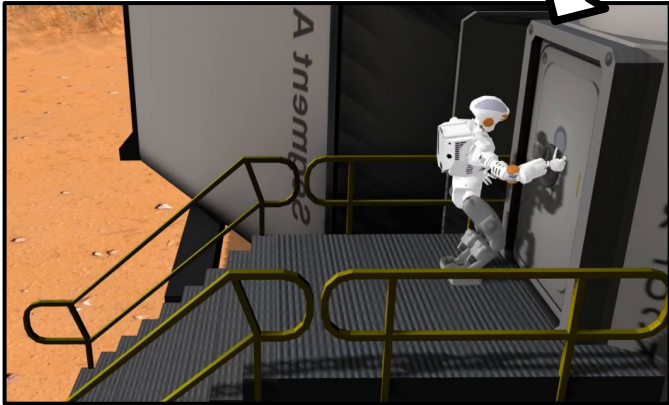

same
code!

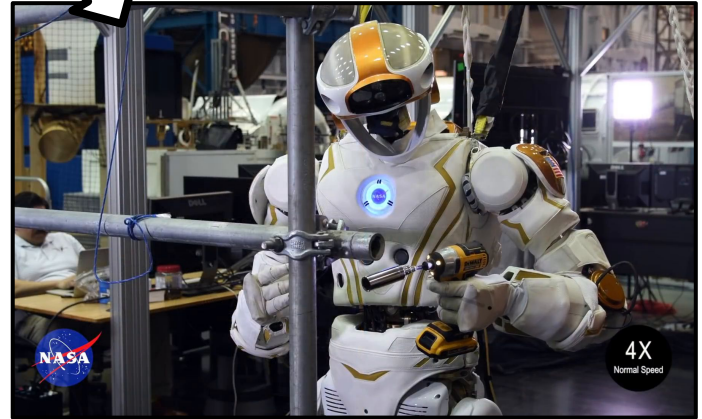

Join a great community of roboticists:

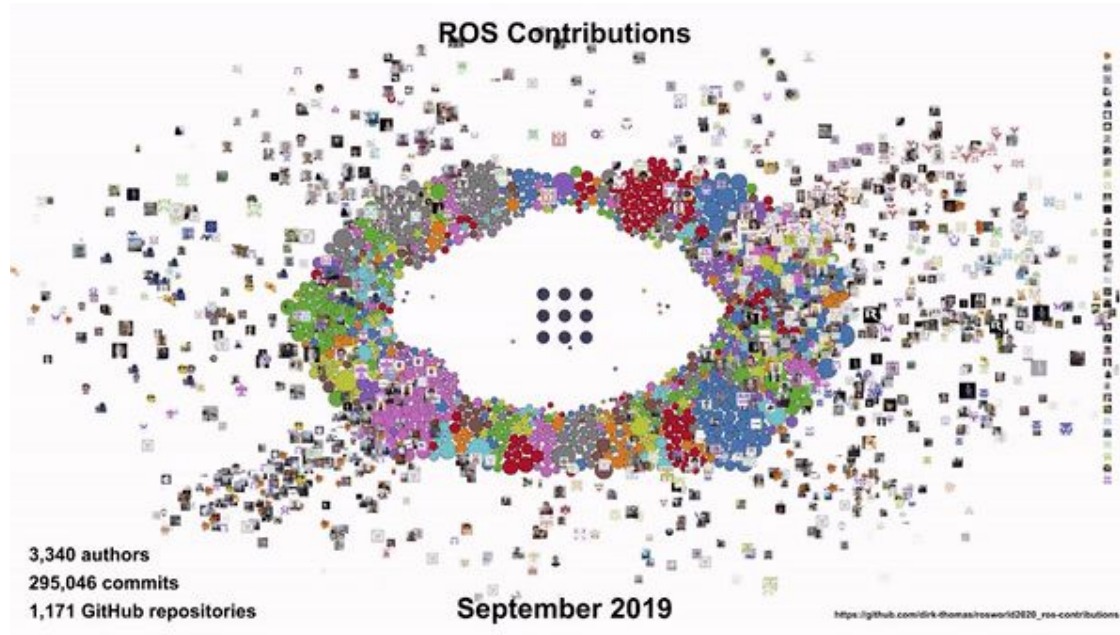

ROS 2 Technical Steering Committee (TSC)



Manage roadmap



Contribute development effort



Set developer policies



Community Events: ROSCon



(some)Community Events in 2019/20/21:

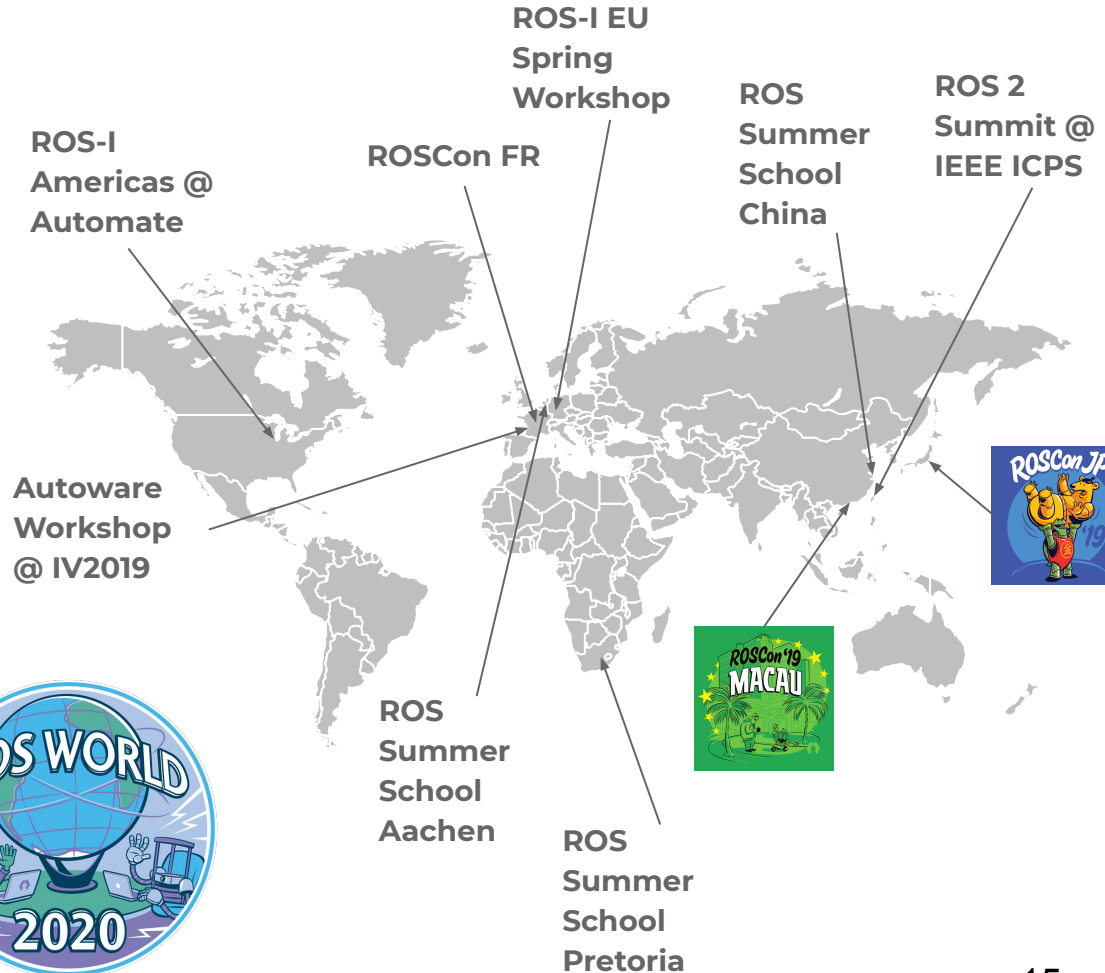
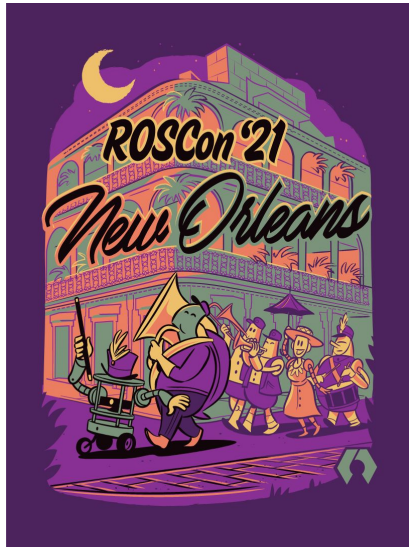

Where to start?

ROS

- ros.org
- index.ros.org
- answers.ros.org
- discourse.ros.org



- gazebosim.org
- ignitionrobotics.org
- answers.gazebosim.org
- community.gazebosim.org

RMF

- osrf.github.io/ros2multirobotbook
- github.com/osrf/rmf_demos
- github.com/osrf/rmf_core



**Join the robot
revolution!**

www.openrobotics.org

